

**NOTE:**  
SEE APPROACH SLAB COMMON DETAILS FOR SECTIONS AND DETAILS NOT SHOWN.

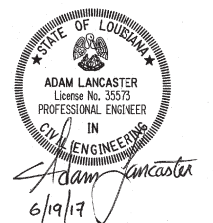

SHEET NUMBER	PARISH	CONTROL SECTION	STATE PROJECT
DESIGNED A. LANCASTER	DESIGNED A. LANCASTER	CHECKED R. MORVANT	CHECKED J. W. P.
REVIEWED Z. Z. FU	SERIES # 1 OF 2	DATE	NO.
REVISION OR CHANGE ORDER DESCRIPTION	BY	DATE	NO.
<p style="text-align: center;"><b>APPROACH SLAB DETAILS</b>  <b>40' LONG &amp; 32' CLEAR ROADWAY</b>          SLAB SPANS AND QUAD BEAM BRIDGES</p>			
<p style="text-align: center;">BD.2.10.2.4.01 - APPROACH SLAB</p>			
<p style="text-align: center;">BRIDGE AND STRUCTURAL DESIGN</p>			

ESTIMATED QUANTITIES (ONE 0° SKEWED APPROACH SLAB)						
BAR	NO.	SHORT BAR	VAR. (IN.)	LONG BAR	TOTAL LENGTH	LOCATION
1001	64	-	-	39'-8"	2538'-8"	LONG. IN BOT. OF SLAB
1002	4	-	-	32'-10"	131'-4"	BOTTOM OF EDGE BEAMS
1003	4	-	-	32'-10"	131'-4"	BOTTOM OF EDGE BEAMS
-	-	-	-	-	-	-
-	-	-	-	-	-	-
<b>TOTAL NO. 10 BARS = 2801'-4" = 12,054 LBS.</b>						
801	64	-	-	39'-8"	2538'-8"	LONG. IN TOP OF SLAB
802	160	-	-	31'-8"	5066'-8"	TRANSV. IN TOP & BOT. OF SLAB
-	-	-	-	-	-	-
-	-	-	-	-	-	-
-	-	-	-	-	-	-
-	-	-	-	-	-	-
-	-	-	-	-	-	-
<b>TOTAL NO. 8 BARS = 7605'-4" = 20,306 LBS.</b>						
501	14	-	-	31'-8"	443'-4"	TOP & BOT. OF SLEEPER SLAB
502	86	-	-	4'-8"	401'-4"	TOP & BOT. OF SLEEPER SLAB
<b>TOTAL NO. 5 BARS = 844'-8" = 881 LBS.</b>						
401	44	-	-	2'-7"	113'-8"	DOWELS IN CURBS
402	2	-	-	13'-1"	26'-2"	LONG. IN CURBS
403	66	-	-	2'-2"	143'-0"	STIRRUPS IN EDGE BEAMS
404	2	-	-	31'-8"	63'-4"	BOTTOM OF HAUNCH
405	40	-	-	4'-8"	186'-8"	STIRRUPS IN HAUNCH
406	4	-	-	13'-2"	52'-8"	LONG. IN CURBS
-	-	-	-	-	-	-
<b>TOTAL NO. 4 BARS = 585'-6" = 391 LBS.</b>						
<b>TOTAL DEFORMED REINFORCING STEEL</b>						<b>33,632 LBS.</b>
<b>CONCRETE APPROACH SLAB</b>						<b>1,280 SQ. FT.</b>

ESTIMATED QUANTITIES (ONE 30° SKEWED APPROACH SLAB)						
BAR	NO.	SHORT BAR	VAR. (IN.)	LONG BAR	TOTAL LENGTH	LOCATION
1001	64	30'-6"	3.46"	48'-8"	2533'-4"	LONG. IN BOT. OF SLAB
1002	4	-	-	41'-7"	166'-4"	BOTTOM OF EDGE BEAMS
1003	4	-	-	23'-8"	94'-8"	BOTTOM OF EDGE BEAMS
-	-	-	-	-	-	-
-	-	-	-	-	-	-
<b>TOTAL NO. 10 BARS = 2794'-4" = 12,024 LBS.</b>						
801	64	30'-6"	3.46"	48'-8"	2533'-4"	LONG. IN TOP OF SLAB
802	122	-	-	31'-8"	3863'-4"	TRANSV. IN TOP & BOT. OF SLAB
803	70	2'-0"	10.41"	31'-6"	1172'-6"	TRANSV. IN TOP & BOT. OF SLAB
804	4	-	-	36'-6"	146'-0"	TOP & BOT. OF SLAB ALONG SKEW
-	-	-	-	-	-	-
-	-	-	-	-	-	-
<b>TOTAL NO. 8 BARS = 7715'-2" = 20,600 LBS.</b>						
501	14	-	-	31'-8"	443'-4"	TOP & BOT. OF SLEEPER SLAB
502	86	-	-	4'-8"	401'-4"	TOP & BOT. OF SLEEPER SLAB
<b>TOTAL NO. 5 BARS = 844'-8" = 881 LBS.</b>						
401	44	-	-	2'-7"	113'-8"	DOWELS IN CURBS
402	2	-	-	13'-1"	26'-2"	LONG. IN CURBS
403	66	-	-	2'-2"	143'-0"	STIRRUPS IN EDGE BEAMS
404	2	-	-	36'-6"	73'-0"	BOTTOM OF HAUNCH
405	47	-	-	4'-8"	219'-4"	STIRRUPS IN HAUNCH
406	4	-	-	13'-2"	52'-8"	LONG. IN CURBS
-	-	-	-	-	-	-
<b>TOTAL NO. 4 BARS = 627'-10" = 419 LBS.</b>						
<b>TOTAL DEFORMED REINFORCING STEEL</b>						<b>33,924 LBS.</b>
<b>CONCRETE APPROACH SLAB</b>						<b>1,280 SQ. FT.</b>

ESTIMATED QUANTITIES (ONE 15° SKEWED APPROACH SLAB)						
BAR	NO.	SHORT BAR	VAR. (IN.)	LONG BAR	TOTAL LENGTH	LOCATION
1001	64	35'-5"	1.60"	43'-10"	2536'-0"	LONG. IN BOT. OF SLAB
1002	4	-	-	36'-11"	147'-8"	BOTTOM OF EDGE BEAMS
1003	4	-	-	28'-7"	114'-4"	BOTTOM OF EDGE BEAMS
-	-	-	-	-	-	-
-	-	-	-	-	-	-
<b>TOTAL NO. 10 BARS = 2798'-0" = 12,040 LBS.</b>						
801	64	35'-5"	1.60"	43'-10"	2536'-0"	LONG. IN TOP OF SLAB
802	142	-	-	31'-8"	4496'-8"	TRANSV. IN TOP & BOT. OF SLAB
803	32	3'-0"	22.40"	31'-0"	544'-0"	TRANSV. IN TOP & BOT. OF SLAB
804	4	-	-	32'-9"	131'-0"	TOP & BOT. OF SLAB ALONG SKEW
-	-	-	-	-	-	-
-	-	-	-	-	-	-
<b>TOTAL NO. 8 BARS = 7707'-8" = 20,580 LBS.</b>						
501	14	-	-	31'-8"	443'-4"	TOP & BOT. OF SLEEPER SLAB
502	86	-	-	4'-8"	401'-4"	TOP & BOT. OF SLEEPER SLAB
<b>TOTAL NO. 5 BARS = 844'-8" = 881 LBS.</b>						
401	44	-	-	2'-7"	113'-8"	DOWELS IN CURBS
402	2	-	-	13'-1"	26'-2"	LONG. IN CURBS
403	66	-	-	2'-2"	143'-0"	STIRRUPS IN EDGE BEAMS
404	2	-	-	32'-9"	65'-6"	BOTTOM OF HAUNCH
405	42	-	-	4'-8"	196'-0"	STIRRUPS IN HAUNCH
406	4	-	-	13'-2"	52'-8"	LONG. IN CURBS
-	-	-	-	-	-	-
<b>TOTAL NO. 4 BARS = 597'-0" = 399 LBS.</b>						
<b>TOTAL DEFORMED REINFORCING STEEL</b>						<b>33,900 LBS.</b>
<b>CONCRETE APPROACH SLAB</b>						<b>1,280 SQ. FT.</b>

ESTIMATED QUANTITIES (ONE 45° SKEWED APPROACH SLAB)						
BAR	NO.	SHORT BAR	VAR. (IN.)	LONG BAR	TOTAL LENGTH	LOCATION
1001	64	23'-10"	6.0"	55'-4"	2533'-4"	LONG. IN BOT. OF SLAB
1002	4	-	-	48'-0"	192'-0"	BOTTOM OF EDGE BEAMS
1003	4	-	-	17'-0"	68'-0"	BOTTOM OF EDGE BEAMS
-	-	-	-	-	-	-
-	-	-	-	-	-	-
<b>TOTAL NO. 10 BARS = 2793'-4" = 12,020 LBS.</b>						
801	64	23'-10"	6.0"	55'-4"	2533'-4"	LONG. IN TOP OF SLAB
802	96	-	-	31'-8"	3040'-0"	TRANSV. IN TOP & BOT. OF SLAB
803	120	1'-10"	6.0"	31'-4"	1990'-0"	TRANSV. IN TOP & BOT. OF SLAB
804	4	-	-	44'-9"	179'-0"	TOP & BOT. OF SLAB ALONG SKEW
-	-	-	-	-	-	-
-	-	-	-	-	-	-
<b>TOTAL NO. 8 BARS = 7742'-4" = 20,672 LBS.</b>						
501	14	-	-	31'-8"	443'-4"	TOP & BOT. OF SLEEPER SLAB
502	86	-	-	4'-8"	401'-4"	TOP & BOT. OF SLEEPER SLAB
<b>TOTAL NO. 5 BARS = 844'-8" = 881 LBS.</b>						
401	44	-	-	2'-7"	113'-8"	DOWELS IN CURBS
402	2	-	-	13'-1"	26'-2"	LONG. IN CURBS
403	66	-	-	2'-2"	143'-0"	STIRRUPS IN EDGE BEAMS
404	2	-	-	46'-6"	93'-0"	BOTTOM OF HAUNCH
405	57	-	-	4'-8"	266'-0"	STIRRUPS IN HAUNCH
406	4	-	-	13'-2"	52'-8"	LONG. IN CURBS
-	-	-	-	-	-	-
<b>TOTAL NO. 4 BARS = 694'-6" = 464 LBS.</b>						
<b>TOTAL DEFORMED REINFORCING STEEL</b>						<b>34,037 LBS.</b>
<b>CONCRETE APPROACH SLAB</b>						<b>1,280 SQ. FT.</b>

**NOTES:**

- Δ 1. QUANTITIES SHOWN FOR 401, 402 AND 406 BARS ARE FOR A 13'-6" CURB (SEE APPROACH SLAB DETAIL "P"). ADJUST QUANTITIES AS NEEDED FOR LONGER CURBS OR FOR "BRIDGE END DRAIN SYSTEM" INSTALLATIONS. BRIDGES WITHOUT GUARDRAIL OR END DRAINS DO NOT REQUIRE A CURB, UNLESS OTHERWISE STATED IN THE PLANS.
- 2. ALL MATERIAL TO BE PAID FOR UNDER ITEM "CONCRETE APPROACH SLABS (CAST-IN-PLACE)." QUANTITIES ARE FOR INFORMATION PURPOSES ONLY.
- ☒ 3. FOR HANDLING PURPOSES, #4 BARS OVER 40' MAY BE SPLICED WITH A 1'-9" MIN. LAP SPLICE. ALL SPLICES TO BE STAGGERED. (1'-9" SPLICE INCLUDED IN ESTIMATED QUANTITIES.)

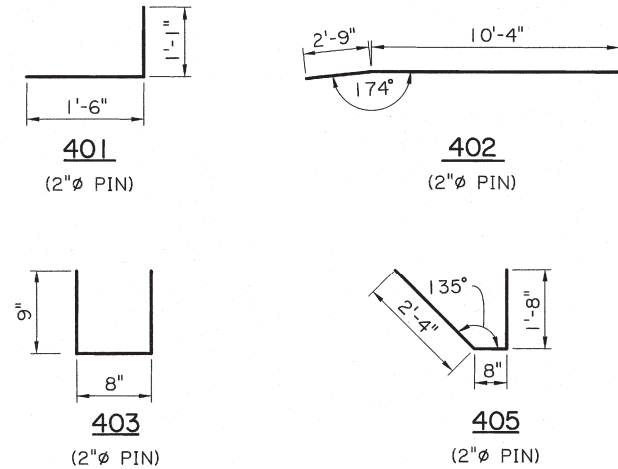

VARIABLES (SEE PLAN VIEW, SHT. 1 OF 2)			
VARIABLE	15° SKEW	30° SKEW	45° SKEW
N <sub>1</sub>	70	60	47
N <sub>2</sub>	15	34	59
N <sub>3</sub>	36	41	48
N <sub>4</sub>	28	23	16
L <sub>1</sub>	35'-0"	30'-0"	23'-6"
L <sub>2</sub>	7'-6"	17'-0"	29'-6"
L <sub>3</sub>	35'-6"	40'-6"	47'-3"
L <sub>4</sub>	27'-2"	22'-3"	15'-6"
L <sub>5</sub>	44'-3/2"	49'-3"	56'-0"
L <sub>6</sub>	35'-8/2"	30'-9/4"	24'-0"

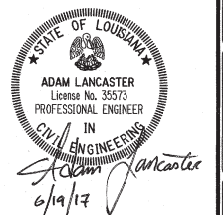
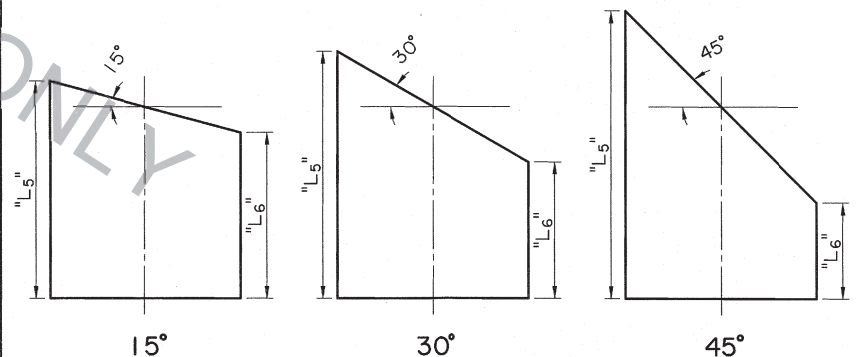

SHEET NUMBER				
DESIGNED	A. LANCASTER	CHECKED	R. MORVANT	PARISH
DETAILED	A. LANCASTER	CHECKED	A. LANCASTER	CONTROL SECTION
REVIEWED	Z.Z. FU	SERIES #	2 OF 2	STATE PROJECT
REVISION OR CHANGE ORDER DESCRIPTION				
BY				
DATE				
NO.				
<b>APPROACH SLAB QUANTITIES</b> <b>40' LONG &amp; 32' CLEAR ROADWAY</b> <b>SLAB SPANS AND QUAD BEAM BRIDGES</b>				
BD.2.10.2.4.02 - APPROACH SLAB				
BRIDGE AND STRUCTURAL DESIGN				

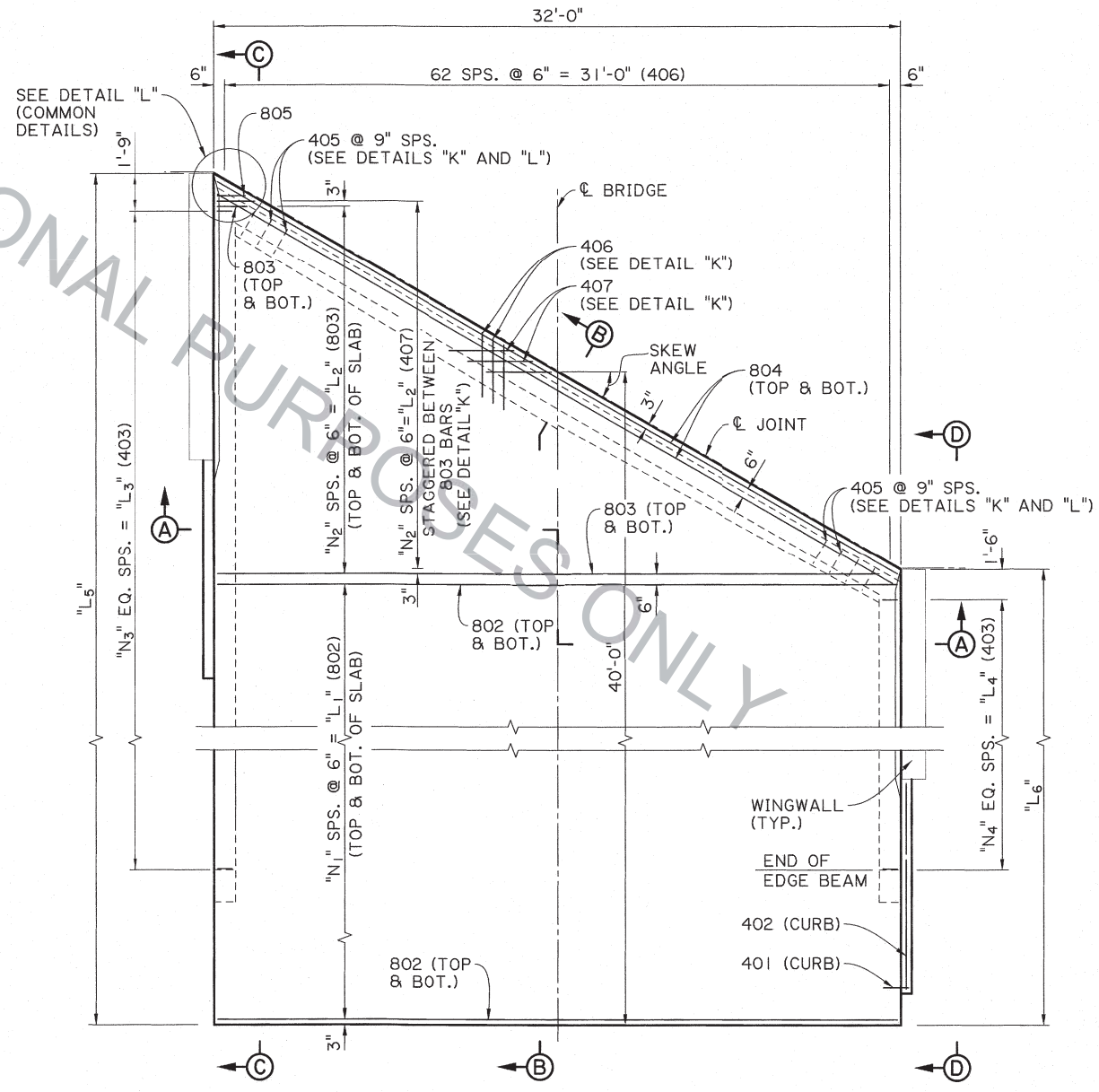
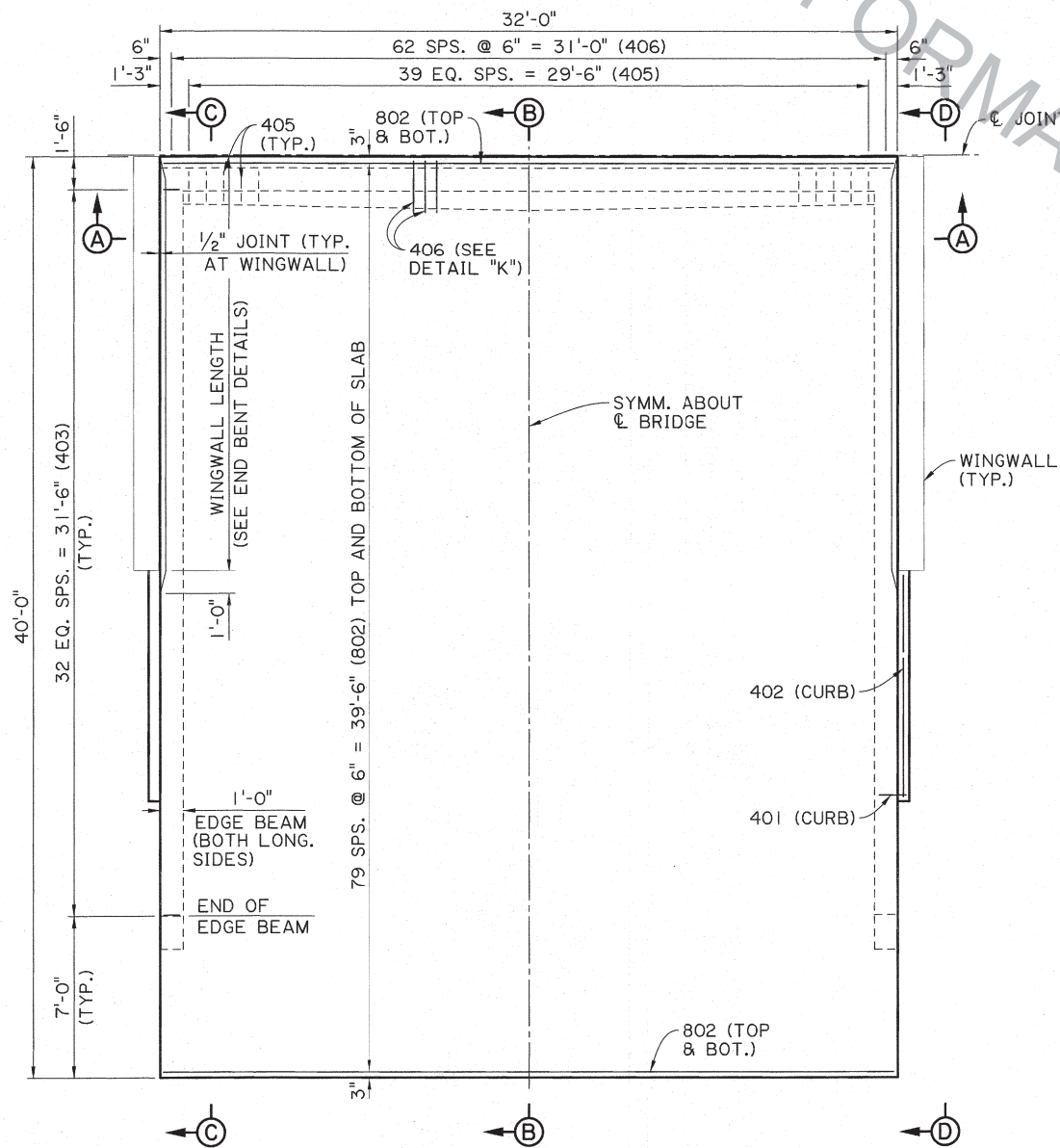
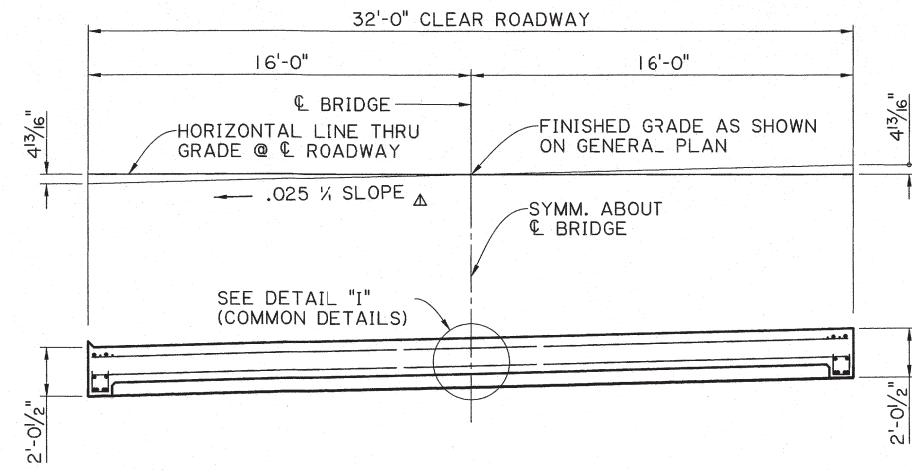
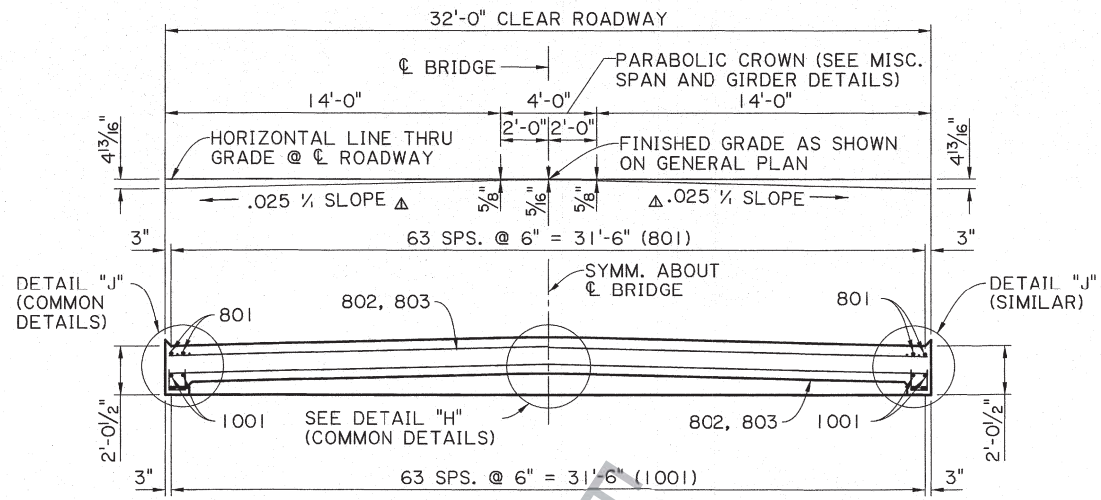

**NOTE:**  
SEE APPROACH SLAB COMMON DETAILS  
FOR SECTIONS AND DETAILS NOT SHOWN

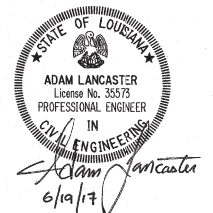

SHEET NUMBER		PARISH		CONTROL SECTION		STATE PROJECT	
DESIGNED A. LANCASTER		A. LANCASTER		A. LANCASTER		REVIEWED Z.Z. FU	
CHECKED R. MORVANT		A. LANCASTER		A. LANCASTER		SERIES # 1 OF 2	
DATE		NO.		REVISION OR CHANGE ORDER DESCRIPTION		BY	
APPROACH SLAB DETAILS		40' LONG & 32' CLEAR ROADWAY		GIRDER SPANS EXCLUDING QUAD BEAMS		BD.2.10.2.4.03 - APPROACH SLAB	
BRIDGE AND STRUCTURAL DESIGN		DOTD		TRANSPORTATION			

ESTIMATED QUANTITIES (ONE 0° SKEWED APPROACH SLAB)						
BAR NO.	SHORT BAR	VAR. (IN.)	LONG BAR	TOTAL LENGTH	LOCATION	
1001	64	-	39'-2"	2506'-8"	LONG. IN BOT. OF SLAB	
1002	4	-	32'-4"	129'-4"	BOTTOM OF EDGE BEAMS	
1003	4	-	32'-4"	129'-4"	BOTTOM OF EDGE BEAMS	
-	-	-	-	-	-	
-	-	-	-	-	-	
TOTAL NO. 10 BARS = 2765'-4" = 11,899 LBS						
801	64	-	39'-2"	2506'-8"	LONG. IN TOP OF SLAB	
802	160	-	31'-8"	5066'-8"	TRANSV. IN TOP & BOT. OF SLAB	
-	-	-	-	-	-	
-	-	-	-	-	-	
-	-	-	-	-	-	
-	-	-	-	-	-	
-	-	-	-	-	-	
TOTAL NO. 8 BARS = 7573'-4" = 20,221 LBS						
501	14	-	31'-8"	443'-4"	TOP & BOT. OF SLEEPER SLAB	
502	86	-	4'-8"	401'-4"	TOP & BOT. OF SLEEPER SLAB	
TOTAL NO. 5 BARS = 844'-8" = 881 LBS						
401	22	-	1'-10"	40'-4"	DOWELS IN CURBS	
402	2	-	13'-1"	26'-2"	LONG. IN CURBS	
403	66	-	2'-2"	143'-0"	STIRRUPS IN EDGE BEAMS	
404	2	-	31'-8"	63'-4"	BOTTOM OF HAUNCH	
405	40	-	4'-8"	186'-8"	STIRRUPS IN HAUNCH	
406	63	-	3'-1"	194'-3"	LONG. IN TOP OF SLAB	
-	-	-	-	-	-	
TOTAL NO. 4 BARS = 653'-9" = 437 LBS						
TOTAL DEFORMED REINFORCING STEEL					33,438 LBS.	
CONCRETE APPROACH SLAB					1,280 SQ. FT.	

ESTIMATED QUANTITIES (ONE 15° SKEWED APPROACH SLAB)						
BAR NO.	SHORT BAR	VAR. (IN.)	LONG BAR	TOTAL LENGTH	LOCATION	
1001	64	34'-11"	1.60"	43'-4"	2504'-0"	LONG. IN BOT. OF SLAB
1002	4	-	-	36'-4"	145'-4"	BOTTOM OF EDGE BEAMS
1003	4	-	-	28'-1"	112'-4"	BOTTOM OF EDGE BEAMS
-	-	-	-	-	-	-
-	-	-	-	-	-	-
TOTAL NO. 10 BARS = 2761'-8" = 11,883 LBS						
801	64	34'-11"	1.60"	43'-4"	2504'-0"	LONG. IN TOP OF SLAB
802	140	-	-	31'-8"	4433'-4"	TRANSV. IN TOP & BOT. OF SLAB
803	32	3'-0"	22.40"	31'-0"	544'-0"	TRANSV. IN TOP & BOT. OF SLAB
804	4	-	-	32'-9"	131'-0"	TOP & BOT OF SLAB ALONG SKEW
805	2	-	-	1'-6"	3'-0"	CORNER OF SLAB
-	-	-	-	-	-	-
-	-	-	-	-	-	-
TOTAL NO. 8 BARS = 7615'-4" = 20,333 LBS						
501	14	-	-	31'-8"	443'-4"	TOP & BOT. OF SLEEPER SLAB
502	86	-	-	4'-8"	401'-4"	TOP & BOT. OF SLEEPER SLAB
TOTAL NO. 5 BARS = 844'-8" = 881 LBS						
401	22	-	-	1'-10"	40'-4"	DOWELS IN CURBS
402	2	-	-	13'-1"	26'-2"	LONG. IN CURBS
403	66	-	-	2'-2"	143'-0"	STIRRUPS IN EDGE BEAMS
404	2	-	-	32'-9"	65'-6"	BOTTOM OF HAUNCH
405	42	-	-	4'-8"	196'-0"	STIRRUPS IN HAUNCH
406	63	-	-	3'-1"	194'-3"	LONG. IN TOP OF SLAB
407	16	-	-	3'-0"	48'-0"	TRANSV. IN TOP OF SLAB
TOTAL NO. 4 BARS = 713'-3" = 476 LBS						
TOTAL DEFORMED REINFORCING STEEL					33,573 LBS.	
CONCRETE APPROACH SLAB					1,280 SQ. FT.	

**NOTES:**

- 1. QUANTITIES SHOWN FOR 401 AND 402 BARS ARE FOR A 13'-6" CURB (SEE APPROACH SLAB DETAILS "Q"). ADJUST QUANTITIES AS NEEDED FOR LONGER CURBS OR FOR "BRIDGE END DRAIN SYSTEM" INSTALLATIONS. BRIDGES WITHOUT GUARDRAIL OR END DRAINS DO NOT REQUIRE A CURB, UNLESS OTHERWISE STATED IN THE PLANS.
- 2. ALL MATERIAL TO BE PAID FOR UNDER ITEM "CONCRETE APPROACH SLABS (CAST-IN-PLACE)." QUANTITIES ARE FOR INFORMATION PURPOSES ONLY.
- 3. FOR HANDLING PURPOSES, #4 BARS OVER 40' MAY BE SPLICED WITH A 1'-9" MIN. LAP SPLICE. ALL SPLICES TO BE STAGGERED. (1'-9" SPLICE INCLUDED IN ESTIMATED QUANTITIES.)

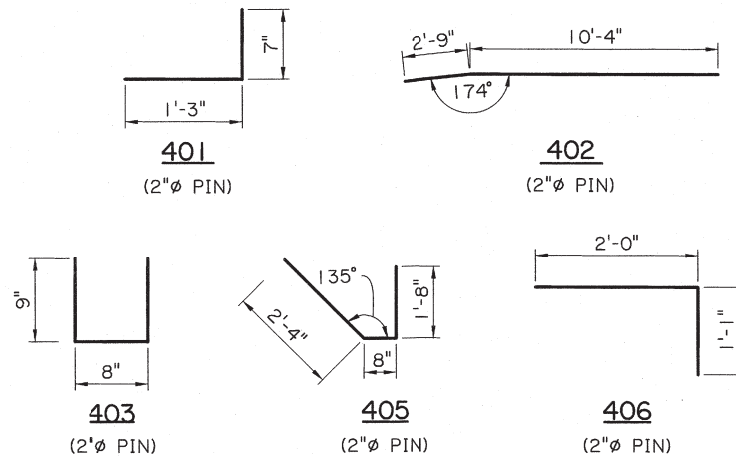

VARIABLES (SEE PLAN VIEW, SHT. 1 OF 2)			
VARIABLE	15° SKEW	30° SKEW	45° SKEW
N <sub>1</sub>	69	59	46
N <sub>2</sub>	15	34	59
N <sub>3</sub>	36	41	48
N <sub>4</sub>	28	23	16
L <sub>1</sub>	34'-6"	29'-6"	23'-0"
L <sub>2</sub>	7'-6"	17'-0"	29'-6"
L <sub>3</sub>	35'-6"	40'-6"	47'-3"
L <sub>4</sub>	27'-2"	22'-3"	15'-6"
L <sub>5</sub>	44'-3 1/2"	49'-3"	56'-0"
L <sub>6</sub>	35'-8 1/2"	30'-9 1/4"	24'-0"

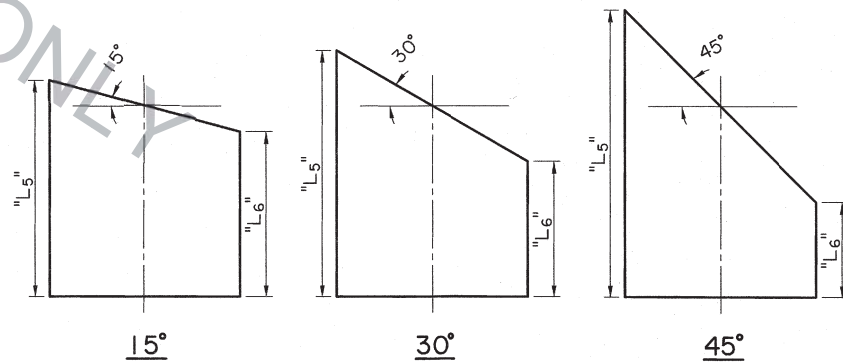

ESTIMATED QUANTITIES (ONE 30° SKEWED APPROACH SLAB)						
BAR NO.	SHORT BAR	VAR. (IN.)	LONG BAR	TOTAL LENGTH	LOCATION	
1001	64	30'-0"	3.46"	48'-2"	2501'-4"	LONG. IN BOT. OF SLAB
1002	4	-	-	41'-0"	164'-0"	BOTTOM OF EDGE BEAMS
1003	4	-	-	23'-2"	92'-8"	BOTTOM OF EDGE BEAMS
-	-	-	-	-	-	-
-	-	-	-	-	-	-
TOTAL NO. 10 BARS = 2758'-0" = 11,868 LBS						
801	64	30'-0"	3.46"	48'-2"	2501'-4"	LONG. IN TOP OF SLAB
802	120	-	-	31'-8"	3800'-0"	TRANSV. IN TOP & BOT. OF SLAB
803	70	1'-11"	10.38"	31'-4"	1163'-9"	TRANSV. IN TOP & BOT. OF SLAB
804	4	-	-	36'-6"	146'-0"	TOP & BOT OF SLAB ALONG SKEW
805	4	-	-	1'-6"	6'-0"	CORNER OF SLAB
-	-	-	-	-	-	-
-	-	-	-	-	-	-
TOTAL NO. 8 BARS = 7617'-1" = 20,338 LBS						
501	14	-	-	31'-8"	443'-4"	TOP & BOT. OF SLEEPER SLAB
502	86	-	-	4'-8"	401'-4"	TOP & BOT. OF SLEEPER SLAB
TOTAL NO. 5 BARS = 844'-8" = 881 LBS						
401	22	-	-	1'-10"	40'-4"	DOWELS IN CURBS
402	2	-	-	13'-1"	26'-2"	LONG. IN CURBS
403	66	-	-	2'-2"	143'-0"	STIRRUPS IN EDGE BEAMS
404	2	-	-	36'-6"	73'-0"	BOTTOM OF HAUNCH
405	46	-	-	4'-8"	214'-8"	STIRRUPS IN HAUNCH
406	63	-	-	3'-1"	194'-3"	LONG. IN TOP OF SLAB
407	35	-	-	2'-0"	70'-0"	TRANSV. IN TOP OF SLAB
TOTAL NO. 4 BARS = 761'-5" = 509 LBS						
TOTAL DEFORMED REINFORCING STEEL					33,596 LBS.	
CONCRETE APPROACH SLAB					1,280 SQ. FT.	

ESTIMATED QUANTITIES (ONE 45° SKEWED APPROACH SLAB)						
BAR NO.	SHORT BAR	VAR. (IN.)	LONG BAR	TOTAL LENGTH	LOCATION	
1001	64	23'-2"	6.0"	54'-8"	2490'-8"	LONG. IN BOT. OF SLAB
1002	4	-	-	47'-4"	189'-4"	BOTTOM OF EDGE BEAMS
1003	4	-	-	16'-4"	65'-4"	BOTTOM OF EDGE BEAMS
-	-	-	-	-	-	-
-	-	-	-	-	-	-
TOTAL NO. 10 BARS = 2745'-4" = 11,813 LBS						
801	64	23'-2"	6.0"	54'-8"	2490'-8"	LONG. IN TOP OF SLAB
802	94	-	-	31'-8"	2976'-8"	TRANSV. IN TOP & BOT. OF SLAB
803	120	1'-8"	6.0"	31'-2"	1970'-0"	TRANSV. IN TOP & BOT. OF SLAB
804	4	-	-	44'-9"	179'-0"	TOP & BOT OF SLAB ALONG SKEW
805	6	-	-	1'-6"	9'-0"	CORNER OF SLAB
-	-	-	-	-	-	-
-	-	-	-	-	-	-
TOTAL NO. 8 BARS = 7625'-4" = 20,360 LBS						
501	14	-	-	31'-8"	443'-4"	TOP & BOT. OF SLEEPER SLAB
502	86	-	-	4'-8"	401'-4"	TOP & BOT. OF SLEEPER SLAB
TOTAL NO. 5 BARS = 844'-8" = 881 LBS						
401	22	-	-	1'-10"	40'-4"	DOWELS IN CURBS
402	2	-	-	13'-1"	26'-2"	LONG. IN CURBS
403	66	-	-	2'-2"	143'-0"	STIRRUPS IN EDGE BEAMS
404	2	-	-	46'-6"	93'-0"	BOTTOM OF HAUNCH
405	56	-	-	4'-8"	261'-4"	STIRRUPS IN HAUNCH
406	63	-	-	3'-1"	194'-3"	LONG. IN TOP OF SLAB
407	60	-	-	2'-0"	120'-0"	TRANSV. IN TOP OF SLAB
TOTAL NO. 4 BARS = 878'-1" = 587 LBS						
TOTAL DEFORMED REINFORCING STEEL					33,641 LBS.	
CONCRETE APPROACH SLAB					1,280 SQ. FT.	

SHEET NUMBER

DESIGNED: A.L. LANCASTER  
CHECKED: R. MORVANT  
DATE: 6/19/17

CONTROL SECTION: A.L. LANCASTER  
REVIEWED: Z.Z. FU  
SERIES #: 2 OF 2

PARISH: LA  
PROJECT: BRIDGE AND STRUCTURAL DESIGN

BY: [Signature]

DATE: [Blank]

REVISION OR CHANGE ORDER DESCRIPTION

NO. [Blank]

APPROACH SLAB QUANTITIES  
40' LONG & 32' CLEAR ROADWAY  
GIRDER SPANS EXCLUDING QUAD BEAMS  
BD.2.10.2.4.04 - APPROACH SLAB

STATE OF LOUISIANA  
ADAM LANCASTER  
License No. 35573  
PROFESSIONAL ENGINEER  
IN  
CIVIL ENGINEERING

DOTD  
TRANSPORTATION